

SCUOLA MEDIA - Sede Nelson Mandela
RIEPILOGO AULE PIANO RIALZATO

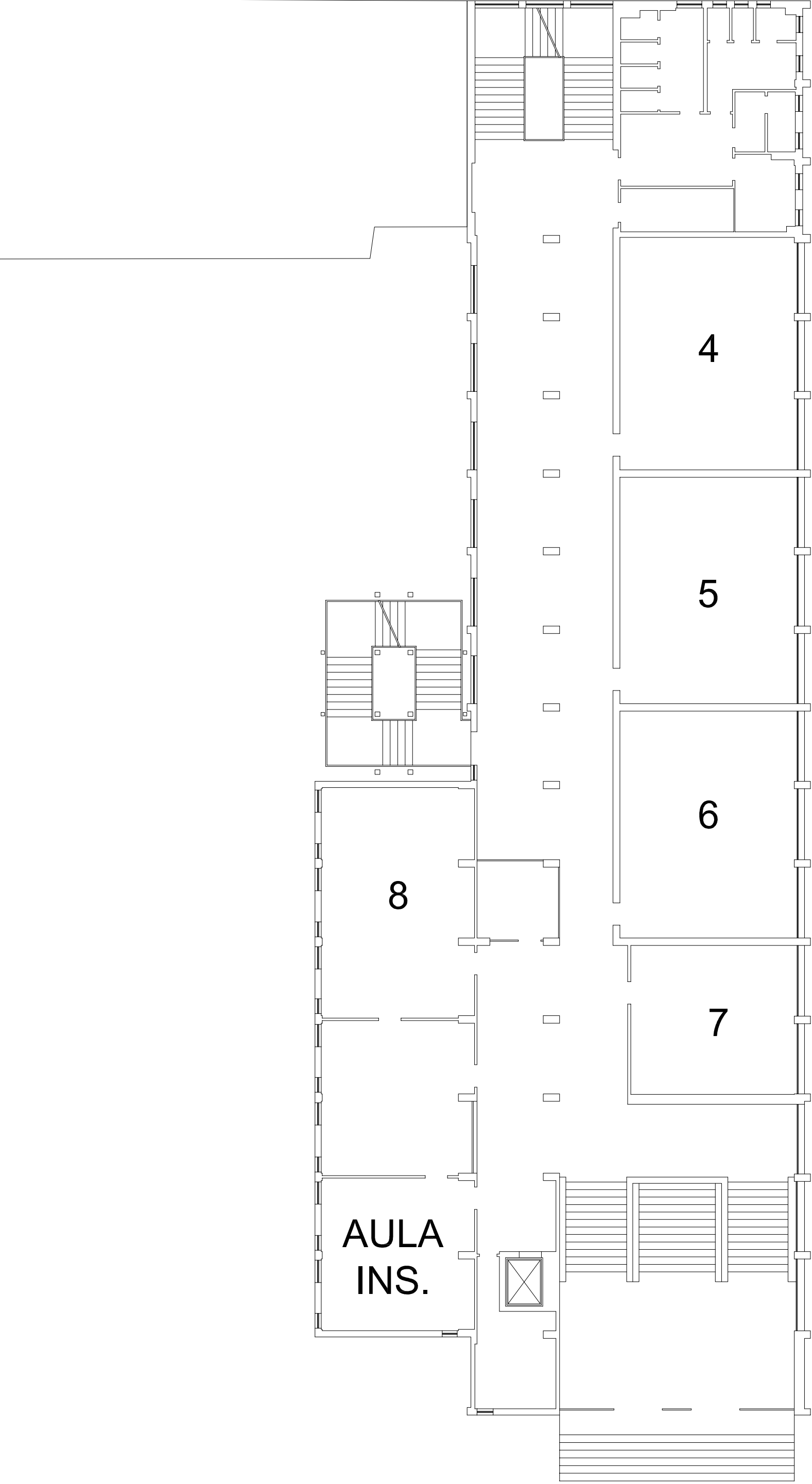

SCUOLA MEDIA - Sede Nelson Mandela
AULA 4 - PIANO RIALZATO
(MAX 29 ALUNNI + DOCENTE)

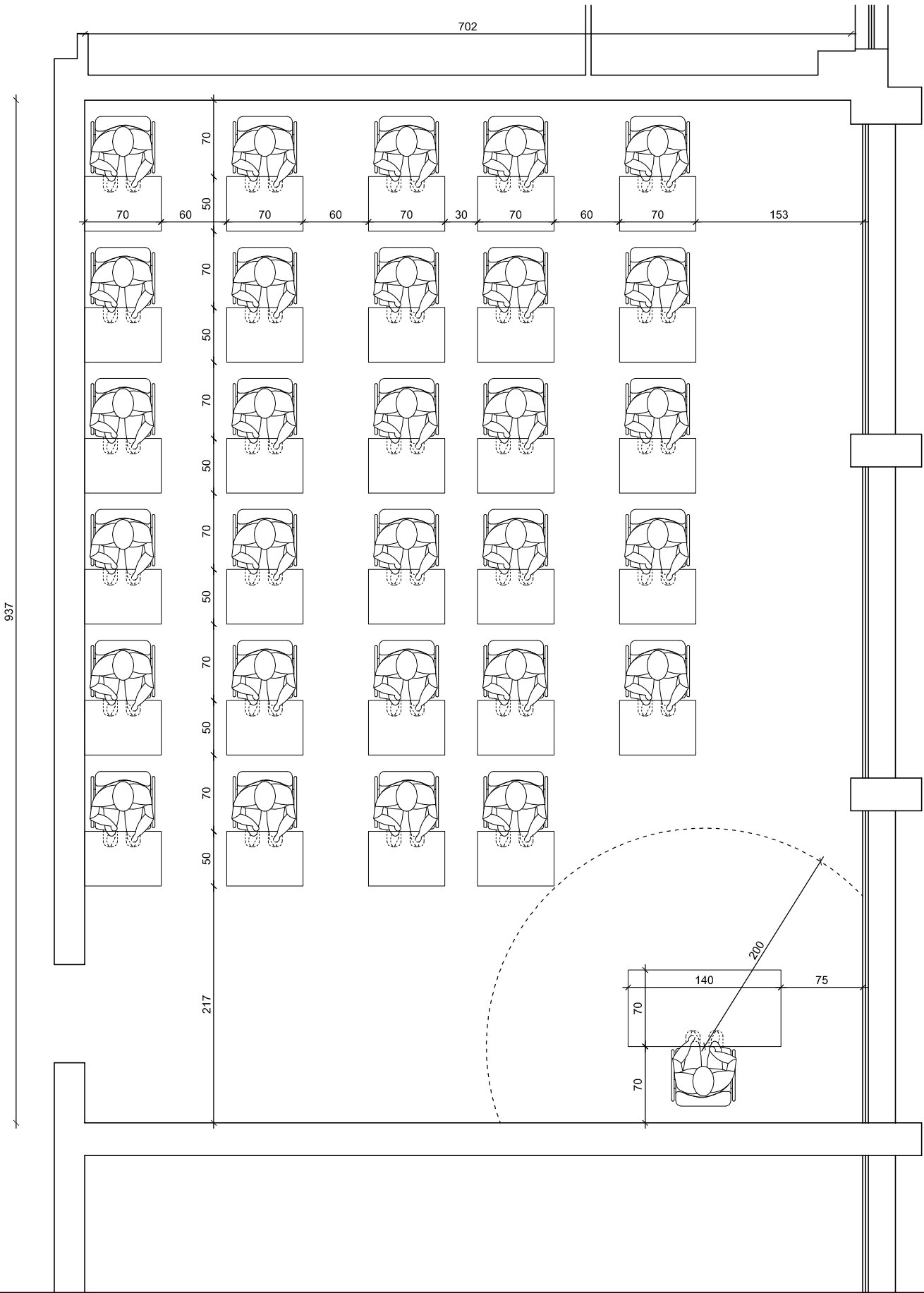

SCUOLA MEDIA - Sede Nelson Mandela
AULA 5 - PIANO RIALZATO
(MAX 29 ALUNNI + DOCENTE)

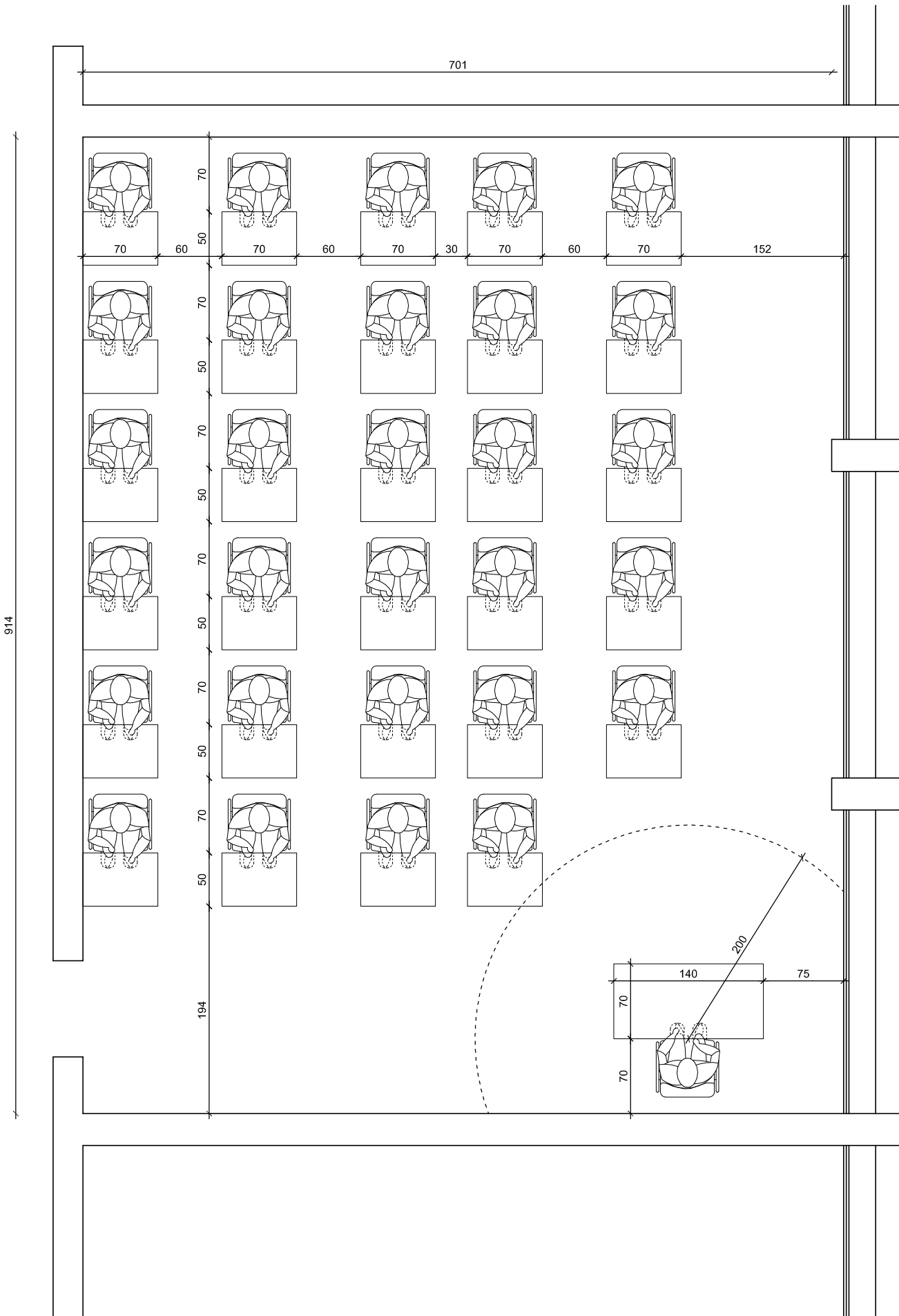

Technical floor plan of a classroom. The room is 702 units wide and 194 units deep. It contains 25 student desks arranged in 5 rows of 5. Each desk is 70 units wide and 50 units deep. The spacing between desks is 60 units horizontally and 70 units vertically. A teacher's desk is located in the bottom right corner, measuring 140 units by 75 units, with a 70-unit deep extension. A dashed arc with a 200-unit radius indicates the teacher's field of view. The total width of the desk area is 153 units, and the total depth is 194 units.

912

SCUOLA MEDIA - Sede Nelson Mandela
AULA 7 - PIANO RIALZATO
(MAX 18 ALUNNI + DOCENTE)

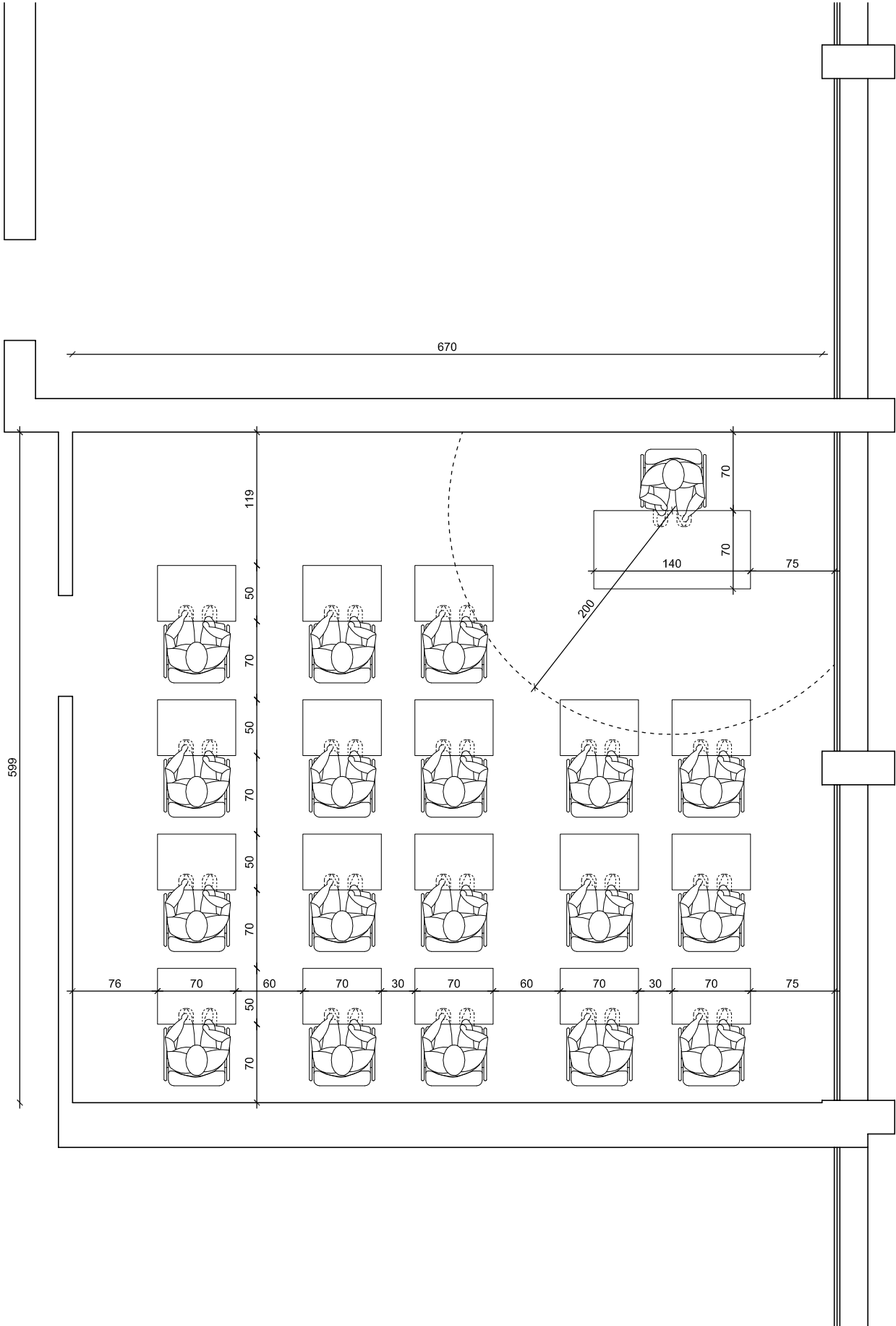

SCUOLA MEDIA - Sede Nelson Mandela
AULA 8 - PIANO RIALZATO
(MAX 27 ALUNNI + DOCENTE)

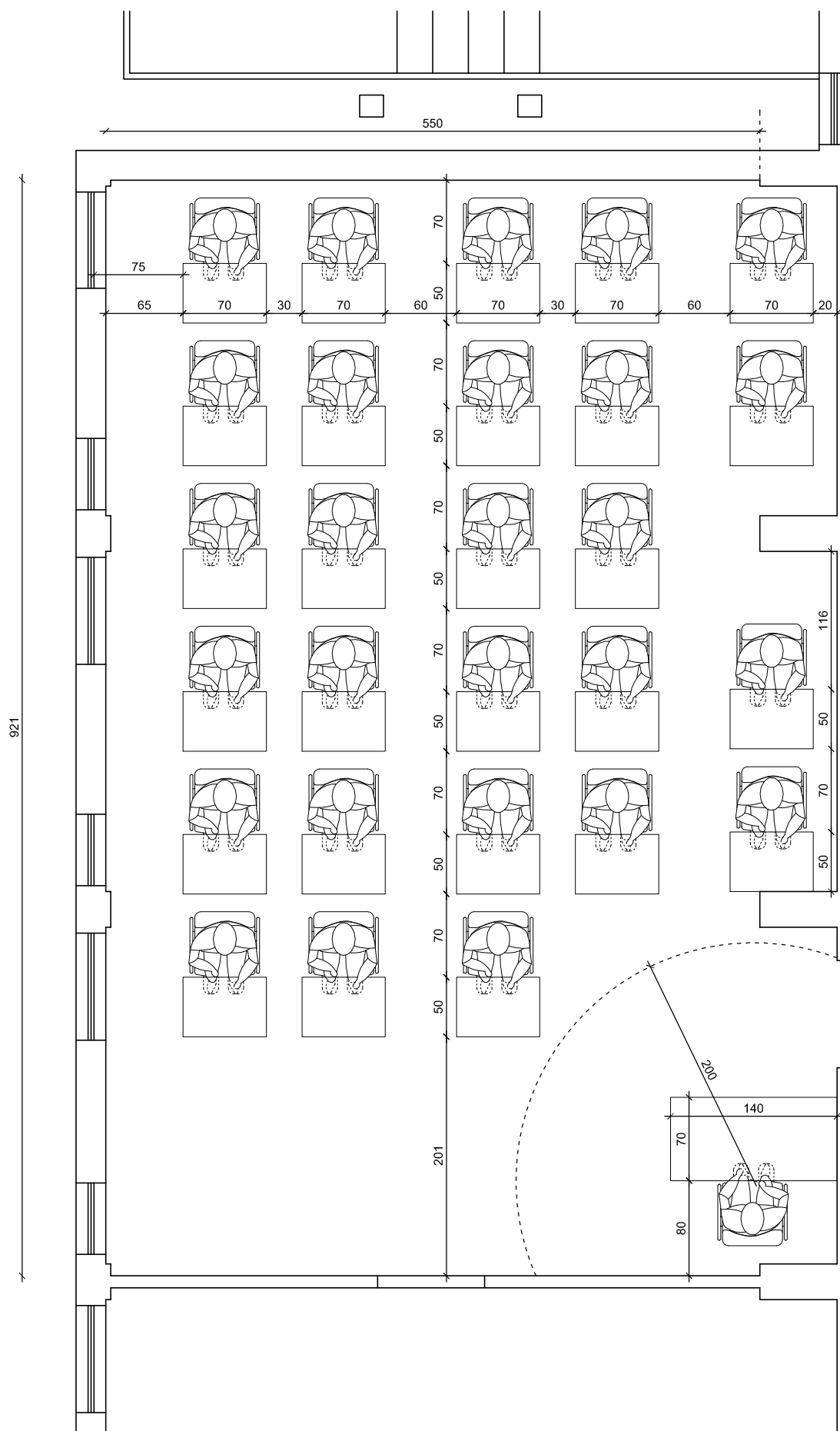

SCUOLA MEDIA - Sede Nelson Mandela
AULA INSEGNANTI - PIANO RIALZATO
(MAX 14 ALUNNI + DOCENTE)

